

Easy Wood Plans

www.easywoodplans.com

#FB, 2316-27Ave N.E.
 Calgary, Alberta
 Canada, T2E 7A7

NOTICE

The purchaser agrees when purchasing this plan (the "Plan") that they shall retain the right to build or construct the object or project set out in the Plan (the "Project") for his/her/its personal use only and not for any commercial purpose. The Plan in whole or in part by any means whatsoever is strictly prohibited.
 3) Blueprints for the Handyman should not be liable for any willful or negligent use of the Plan. The Project designer shall not be held liable for any loss or damage resulting therefrom.

NOTES: Read all directions before beginning

- Changes should be used to reinforce all joints
- Countersink all screws and set all nails
- Dimensions in brackets denote millimeters

Directions

- Lay out your material on the workbench, or on sawhorses, as outlined in the cutting diagram (Fig 1) and layout diagram (Fig 2). Draw out all joints exactly as illustrated, including the letter designations. In period. Ensure to leave a small space between cut lines to allow for the width of the saw blade. When cutting, use the side of the blade that is marked with the correct arrow cutting to ensure they are correct. Always cut to the inside side of the line. When cutting across the grain, tape the edges with masking tape or clamp on 1/8" material to avoid splintering. Sand all edges sanding in a motion from the inside of the wood to the cut. For rabbeting pieces B (Fig 3); if you are using a table saw set the saw depth to 1/2". Test the depth of your blade on a scrap piece of wood before making the actual cut. The cut on piece B is on the 80° edge. After the 1/4" rabbet cut on piece B, mark and drill the thirty four 1/4" dia. holes (assuming your shelf support brackets are 1/4" diameter) using a depth gauge (illustration 1) to a depth of 1/2".

OTHER

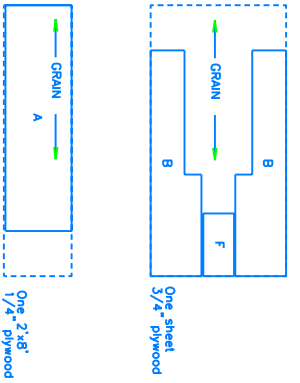

MATERIAL LAYOUT
 FIGURE 1

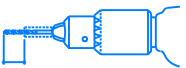
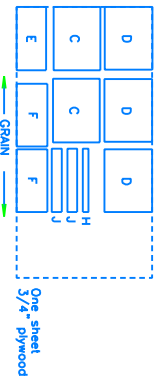

Make a depth gauge for your drill - by drilling through a 3/4" x 3/4" piece of wood with a 3/4" diameter drill bit. The gauge will give desired depth of drill and place over drill bit

DRILL DEPTH GAUGE
 ILLUSTRATION 1

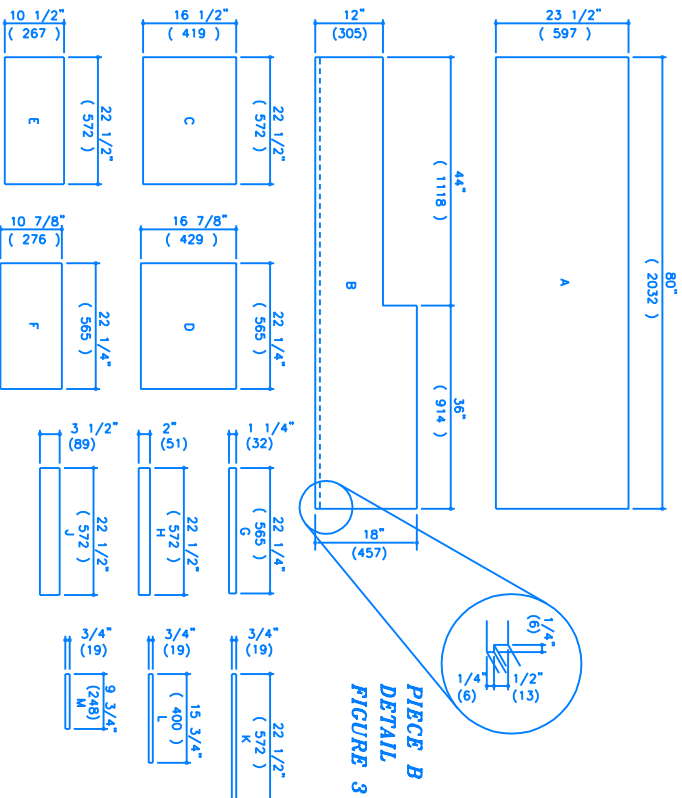

PIECE B
 DETAIL
 FIGURE 3

CUTTING DIAGRAM
 FIGURE 2



MAIL GLIDE LEVELLER

SHELF SUPPORT BRACKETS

MATERIALS LIST

- One 2x8 sheet 1/4" Plywood, good both sides
- Two 4x8 sheets 3/4" Plywood, good both sides
- Two 6 doorstops (1 1/4" x 3/8")
- One 6 1x4 (3/4" x 3 1/2")
- 24 edgetape
- Twelve shelf support brackets
- Approx. 1 lb. 1 1/4" finishing nails

MATERIALS LIST

- Approx. 1/2 lb. 3/4" finishing nails
- Approx. twenty five 1 1/4" #8 flathead screws
- Stain & varnish, or oil
- Sandpaper
- Four glides or levers